

HORIZON DECK

Emerald Waterways Star-Ship

Built: 2014-2017 Speed: 15.5 mph Staterooms: 80 Suites: 12 Length: 443 ft. Crew: 47

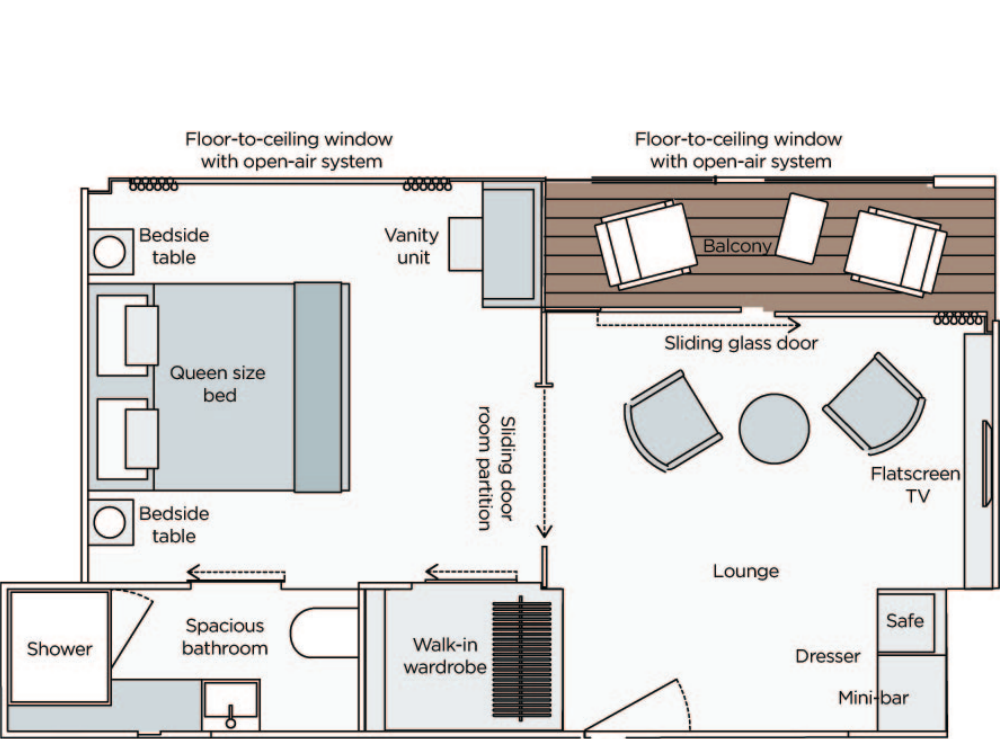
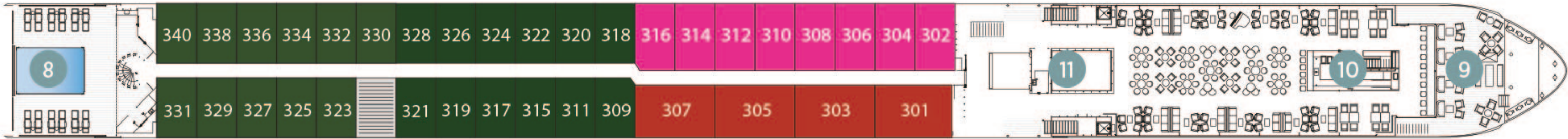

Owner's One-Bedroom Suite

315ft²

SA

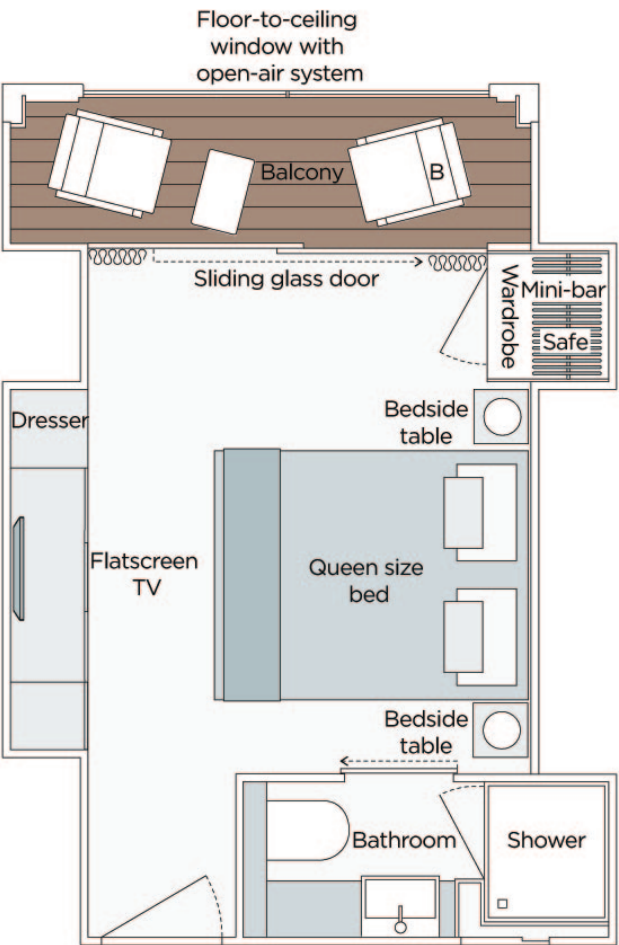

Grand Balcony Suite

210ft²

S

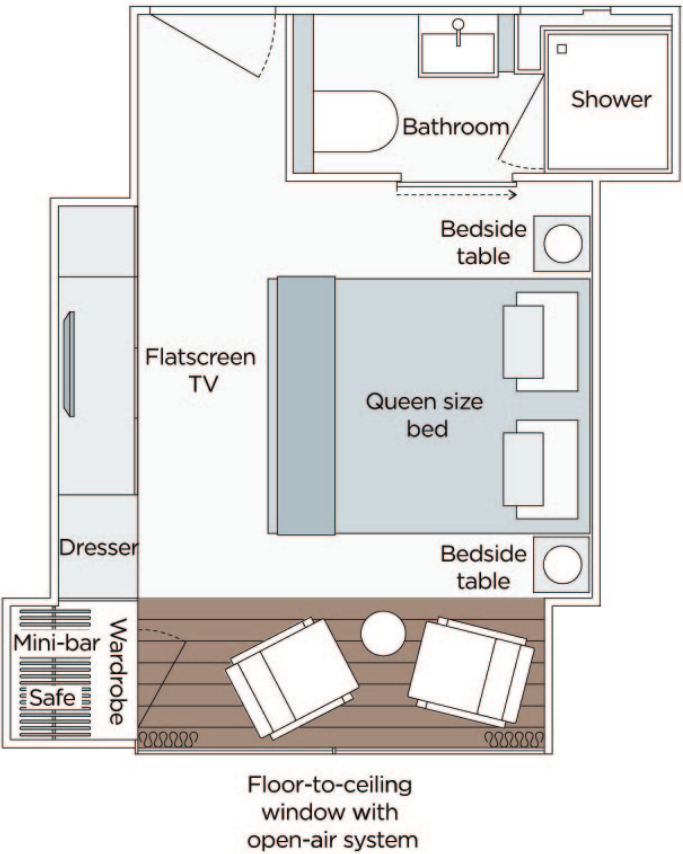

Panorama Balcony Suite

180ft²

A

VISTA DECK

Emerald Waterways Star-Ship

Built: 2014-2017 Speed: 15.5 mph Staterooms: 80 Suites: 12 Length: 443 ft. Crew: 47

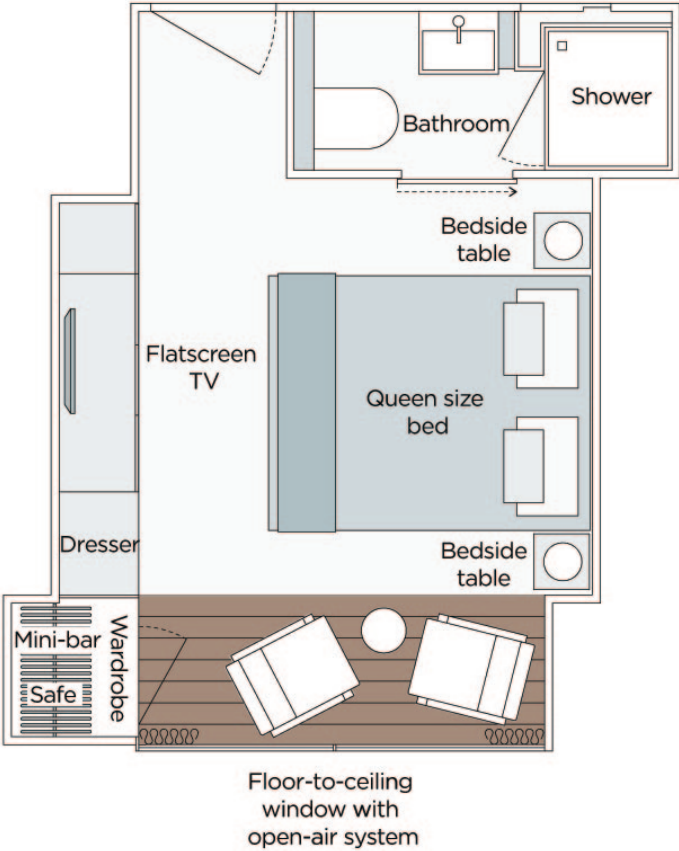

Panorama Balcony Suite

180ft²



RIVIERA DECK

Emerald Waterways Star-Ship

Built: 2014-2017 Speed: 15.5 mph Staterooms: 80 Suites: 12 Length: 443 ft. Crew: 47

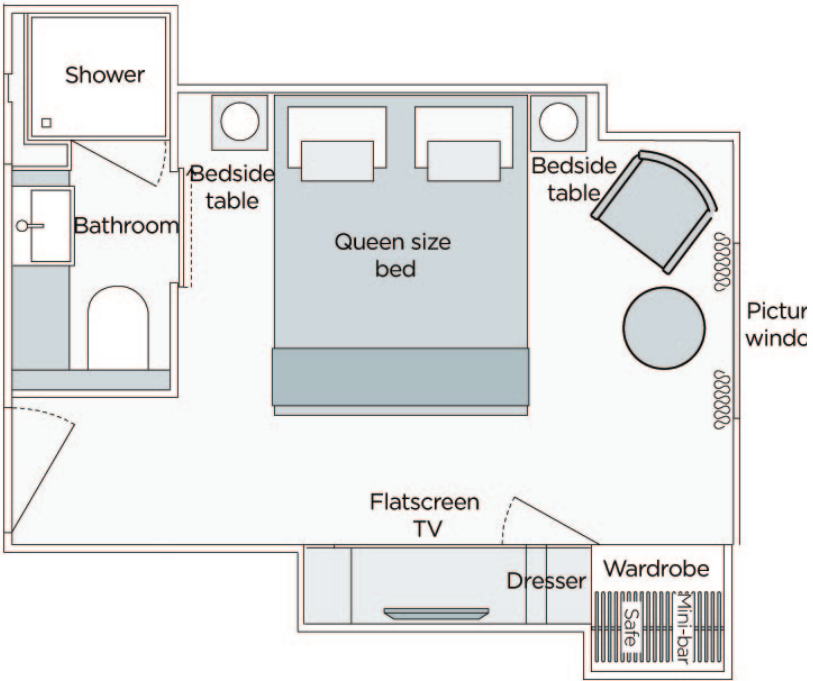

Emerald Stateroom

162ft²





Owner's One-Bedroom Suite **CAT SA**

Our Owner's One-Bedroom Suites boast their very own bedroom which closes off from the rest of the suite. A separate lounge area and outdoor balcony, complete with open-air system, allows you to enjoy the views of your surroundings whatever the weather.

These suites also include a selection of special features including a spacious bathroom, luxurious walk-in wardrobe and Nespresso™ machine. Your complimentary mini-bar is restocked daily and, so you can keep up-to-date with the latest news, you'll have an iPad to use throughout your cruise. In order to offer you a more intimate dining experience, you can also order a continental breakfast, pre-dinner canapés and after-dinner sweet treats to enjoy in the privacy of your suite.

- Between 285ft² and 315ft²
- Outdoor private balcony with open-air system
- Separate bedroom and lounge area
- Bathroom with shower, indulgent toiletries, hair dryer, onboard complimentary bathrobes and slippers
- Walk-in wardrobe
- Complimentary in-suite mini-bar, restocked daily with wine, beer and soft drinks
- Complimentary bottled water, restocked daily
- Complimentary Nespresso™ machine
- Complimentary Wi-Fi
- Use of an iPad
- Queen-size or twin hotel-style beds
- Pillow menu
- Telephone
- Safe for your valuables
- Individual climate control
- Flat screen TV and infotainment system
- Continental breakfast, pre-dinner canapés and after-dinner sweet treats served in your suite
- Four items of laundry per day
- Invitation to dine at the Captain's Table



Grand Balcony Suite **CAT S**

Each of our Grand Balcony Suites boasts a number of fantastic inclusions, such as an in-suite Nespresso™ machine for that added home comfort, so that you can relax with a hot beverage at any time, day or night. You'll also have the option to order a delicious continental breakfast to enjoy on the balcony. And, for the perfect start and finish to your evening meal, you can enjoy pre-dinner canapés and after-dinner sweet treats courtesy of your exclusive room service, which is included in the price of your suite.

Grand Balcony Suites also offer a spacious outdoor balcony, allowing you to make the most of the beautiful landscapes and take in the fresh air. Should the weather take a turn for the worse, you needn't worry because all it takes is the touch of a button and our state-of-the-art open-air system gets to work. The window rises from the balcony and encloses the area so that you can still sit out and admire the views.

Please note: Cabin 316 on the Emerald Waterways Star-Ships has a slightly varied cabin layout. Important Information: the cabin and deck plans, sizes and photographs are an indication only and are subject to variation.

- Between 207ft² and 210ft²
- Outdoor private balcony with open-air system
- Bathroom with shower, indulgent toiletries, hair dryer, onboard complimentary bathrobes and slippers
- In-suite mini-bar available at own expense
- Complimentary bottled water, restocked daily
- Complimentary Nespresso™ machine
- Complimentary Wi-Fi
- Queen-size or twin hotel-style beds
- Pillow menu
- Telephone
- Safe for your valuables
- Individual climate control
- Flat screen TV and infotainment system
- Continental breakfast, pre-dinner canapés and after-dinner sweet treats served in your suite
- Two items of laundry per day



Panorama Balcony Suite CAT A CAT B CAT C

We’ve put every effort into designing beautiful staterooms and suites, selecting the most elegant décor and furnishings to create a haven for you to relax in as you sail through the most picturesque landscapes. But, with our Emerald Panorama Balcony Suite, we’ve gone one step further and created a completely new type of suite that’s unique to European river cruising. These spectacular suites boast our revolutionary indoor balcony design, complete with decking area, table and chairs, generating an entirely new space for you to enjoy the landscapes you pass. With the touch of a button, the upper part of the suite’s floor-to-ceiling window drops down to unveil uninterrupted views of the stunning scenery, opening up the suite and bringing the outdoors in.

- Between 160ft² and 188ft²
- Indoor balcony with open-air system
- Bathroom with shower, indulgent toiletries and hair dryer
- Complimentary bottled water, restocked daily
- Complimentary Wi-Fi
- Queen-size or twin hotel-style beds
- Telephone
- Safe for your valuables
- Individual climate control
- Flat screen TV and infotainment system
- Mini-fridge



Emerald Stateroom CAT D CAT E

All Emerald Staterooms feature a window and a wealth of quality facilities. Plus, they’re bigger than the average standard staterooms on the European rivers, providing excellent value for money.

- Between 153ft² and 170ft²
- Window
- Bathroom with shower, indulgent toiletries and hair dryer
- Complimentary bottled water, restocked daily
- Complimentary Wi-Fi
- Queen-size or twin hotel-style beds
- Telephone
- Safe for your valuables
- Individual climate control
- Flat screen TV and infotainment system
- Mini-fridge

Emerald Waterways Star-Ships

Emerald Sky, Emerald Star, Emerald Sun, Emerald Dawn & Emerald Destiny
Built: 2014-17 Speed: 15.5 mph Staterooms: 19 Suites: 72 Length: 443 ft. Crew: 47
See pages 98-100 for stateroom and suite descriptions and details.

SUN DECK



HORIZON DECK

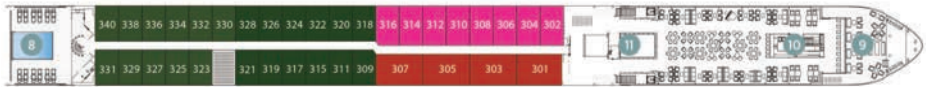

VISTA DECK

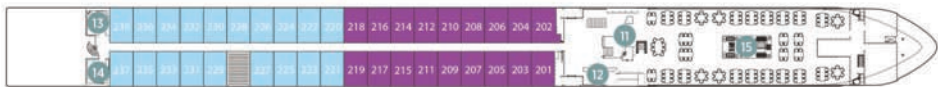

RIVIERA DECK



Public Areas and Ship Amenities

- 1 Sun Deck with Deck Chairs
- 2 Navigation Bridge
- 3 Sky Barbecue
- 4 Golf Putting Green
- 5 Games Area
- 6 Retractable Glass Roof
- 7 Walking Track
- 8 Daytime Pool & Bar / Evening Cinema
- 9 The Terrace
- 10 Horizon Bar and Lounge
- 11 Elevator
- 12 Reception
- 13 Wellness Area
- 14 Fitness Area
- 15 Reflections Restaurant
- 16 Hairdresser



Owner's One-Bedroom Suite
315ft²
CAT SA



Grand Balcony Suite
210ft²
CAT S



Panorama Balcony Suite
180ft²
CAT A CAT B CAT C



Emerald Stateroom
162ft²
CAT D CAT E



Important Information: On *Emerald Sky* and *Emerald Star*, cabin 202 has a modified entry, bathroom configuration with personal assistance fittings and has no decked area with table and chairs. The cabin and deck plans, sizes and photographs are an indication only and are subject to variation. Due to safety, the Sun Deck will be closed when traveling under low bridges.
*Cabin 316 has a slightly varied layout.

